

FIG 280DBB CAST STEEL GLOBE DOUBLE BLOCK & BLEED UNIT PN40 RATING - SIZES 50mm to 250mm

Fig 640 PN40 Bleed Flange								
SIZE	50	65	80	100	125	150	200	250
A	565	617	667	769	869	971	1123	1315
B	285	321	324	394	460	553	678	780
C	165	177	182	200	217	235	270	307
D	311	337	362	413	463	514	590	686
E	200	200	200	250	315	400	530	530
F	50	50	50	50	50	50	50	50
G	165	195	200	235	270	305	375	450
H	150	150	160	170	200	190	225	225
J	M16	M16	M16	M20	M24	M24	M27	M30
WGT. (kg)	50	65	80	100	125	150	200	250
280DBB	55	72	87	133	206	293	460	721
640	9	10	11	15	20	23	30	41

All dimensions are in mm. Weights are approximate.

**THESE VALVES SHOULD BE INSTALLED
WITH THE VALVE HEAD VERTICAL**

FIG. 640 PN40 BLEED FLANGE WITH DRAIN OUTLET
(supplied with blanking flange)

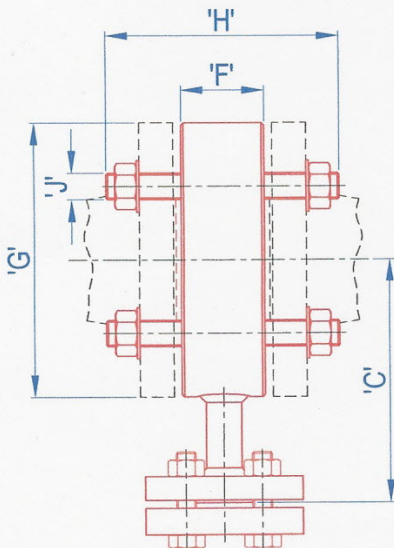

Fig. 280 globe valves are supplied to PN40 rating. Valves can be supplied PN16 rated (refer to PN16 data sheet). Details of other flange ratings supplied upon request.

The Fig. 640 bleed flange is an approved seal welded assembly, consisting of the body, extension tube and Ø15mm PN16-40 flange (or as specified by Customer) in certified carbon steel, B7 tie-rods with 2H nuts and 2 spiral wound graphite filled gaskets (suitable for use on steam).

15mm fig. 280 PN40 rated cast steel globe stop valve is available as a drain valve upon request, replacing the standard blanking flange.

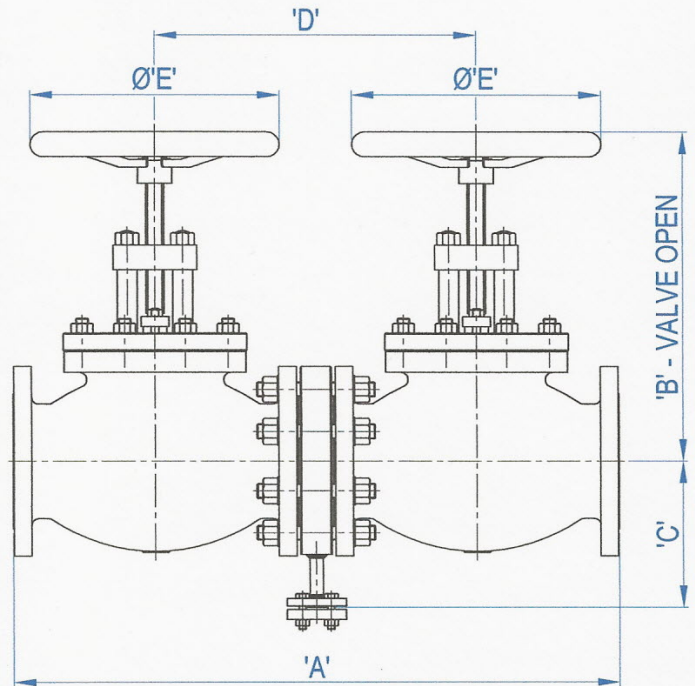
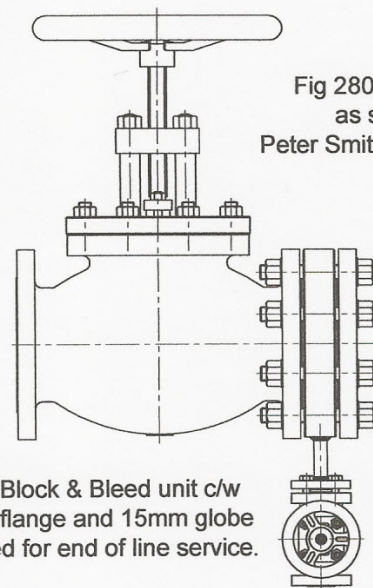

Fig 280 globe valve details are as stated in the current Peter Smith Valve Co. Ltd catalogue.



Double Block & Bleed unit c/w blanking flange and 15mm globe valve used for end of line service.

Additional Fig. 640 Bleed Flanges are available for fitting downstream from the Double Block & Bleed unit assembly to assist drainage of the system and to verify the closure of both of the double isolation valves or for end of line service (as shown)