

CAST IRON GLOBE and ANGLE LIFT CHECK VALVE

FIG: 184

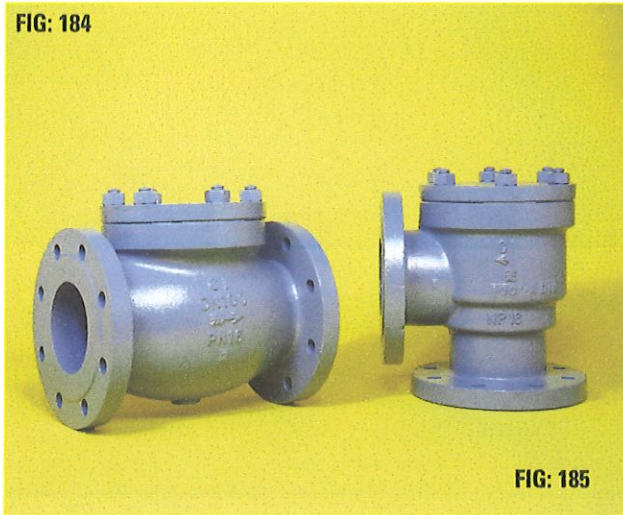

FIG: 185

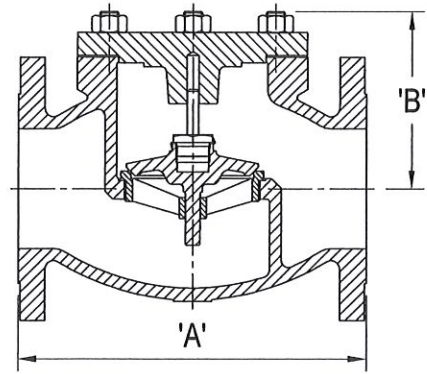

FIG No. 184

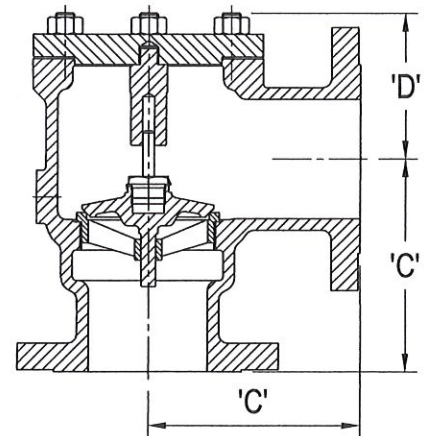

FIG No. 185

PRESSURE / TEMPERATURE RATING:

In accordance with BSI, BS EN 12334 (Formally BS 5153) and ANSI specifications.

For the line flange connection required, refer to the Pressure Temperature Rating Chart in the Technical Data Section of our website.

Max. temp. 180°C - restricted use.

FLANGED:

BS EN 1092-2 PN6, PN10, PN16.
 BS 10 Tables D, E, F.
 ANSI B16.1 Class 125.

CONSTRUCTION:

Bolted cover, top and bottom guided disc.

These valves should be installed with the Valve Head vertical.

Flanges will be drilled unless otherwise specified on order.

MATERIALS:

Body / Cover Cast iron to BS EN 1561 EN GJL 250
 Disc / Seat Ring Gunmetal to BS EN 1982 CC491K
 Alternative trim available: stainless steel.

TYPE OF APPLICATION:

Fluid non-return.

LINE MEDIA:

High temperature hot water.
 Medium temperature hot water.
 Low temperature hot water.
 Cold 'clean' water.

| | | | | | | | | | | |
|-------------------------|-----|-----|-----|-----|-----|-----|-----|-----|-----|-----|
| Nominal Size (Fig. 184) | 25 | 32 | 40 | 50 | 65 | 80 | 100 | 125 | 150 | 200 |
| A | 160 | 180 | 200 | 203 | 216 | 241 | 292 | 330 | 356 | 495 |
| B | 86 | 87 | 87 | 98 | 108 | 120 | 153 | 160 | 163 | 272 |
| Weight Kg. | 8 | 9 | 10 | 12 | 17 | 20 | 31 | 47 | 55 | 128 |

| | | | | | | | | | | |
|-------------------------|-----|-----|-----|-----|-----|-----|-----|-----|-----|-----|
| Nominal Size (Fig. 185) | 25 | 32 | 40 | 50 | 65 | 80 | 100 | 125 | 150 | 200 |
| C | 100 | 105 | 115 | 125 | 145 | 155 | 178 | 203 | 229 | 248 |
| D | 75 | 76 | 76 | 88 | 96 | 108 | 136 | 140 | 153 | 187 |
| Weight Kg. | 7 | 8 | 8 | 13 | 17 | 18 | 35 | 39 | 67 | |