

CAST IRON SWING CHECK VALVE to BS EN 16767

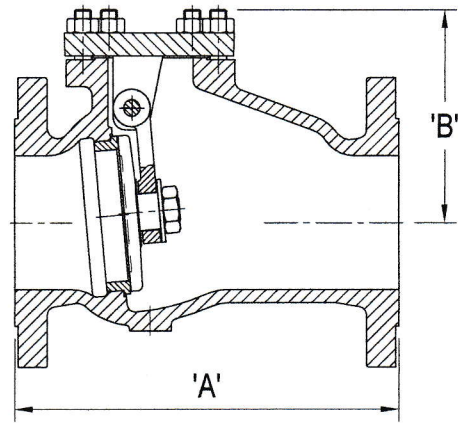
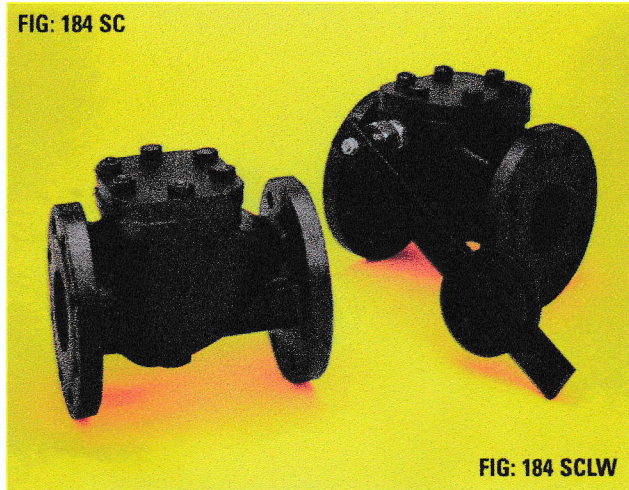

FIG No. 184SC / 184SCLW

PRESSURE / TEMPERATURE RATING:

10 Bar at 0°C to 120°C maximum.

FLANGED:

BS EN 1092-2 PN6, PN10, PN16.
 BS 10 Tables 'D', 'E'.
 ANSI B16.1 Class 125.

OPTIONAL EXTRAS:

- Body and cover tapplings
- By-pass
- Limit switches
- Lever arm guard
- Rubber faced disc (max. temp 65°C)

CONSTRUCTION:

Fig. 184SC - bolted cover flange assembly is removable complete with hinge and disc for maintenance or replacement on site.

Fig. 184SCLW - lever and weight type valves will be supplied with the lever on the right hand side when looking as the valve inlet port as illustrated, unless opposite hand is specified.

Fig. 184SC and Fig. 184SCLW are suitable for horizontal or vertical pipelines (Fig. 184SCLW lever has provision for realignment when vertically mounted).

Flanges will be drilled unless otherwise specified on order.

TYPE OF APPLICATION:

Fluid non-return.

LINE MEDIA:

- Condensate.
- Medium temperature hot water.
- Low temperature hot water.
- Cold 'clean' water.
- Cold 'dirty' water.
- Sewage.
- Effluent.

MATERIALS:

Body / Cover Cast iron to BS EN 1561 EN GJL 250
 Disc / Seat Ring Gunmetal to BS EN 1982 CC491K
 Hinge Pin High tensile brass to BS EN 12164 CW 721 R

Stuffing box, spindle and side plug (184SCLW):
 high tensile brass to BS EN 12164 CW 721 R.

Alternative trim available: stainless steel.

Nominal Size	40	50	65	80	100	125	150	200	250	300
A	200	203	216	241	292	330	356	495	622	698
B	98	114	127	134	153	165	184	273	324	337
Weight Kg.	184SC	11	15	19	21	29	39	54	113	242
	184SCLW	-	-	-	24	32	43	60	123	248